

# HOUSE REGROWTH POD

'.....from little things big things grow'

## inside the pod

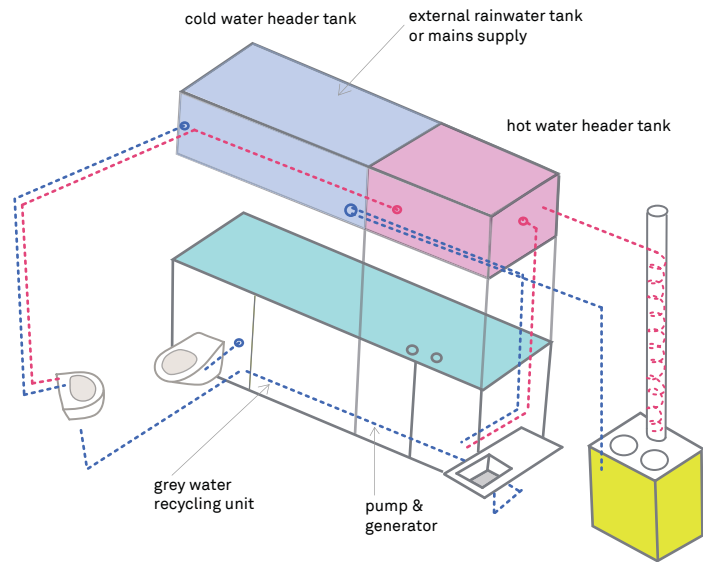

## essential services contained in each pod

- 1 Bathroom**  
 disabled compliant  
 doubles as a fire refuge  
 totally fire compartmented - 2 hours min.  
 fire rated door - 2 hours min  
 toilet - supplied by greywater,  
 sewer pipe out to external septic tank  
 basin - fed from header tanks, wastes  
 to greywater treatment unit  
 shower- fed from header tanks
- 2 Service Zone**  
 accessible from inside  
 totally fire compartmented - 2 hours min  
 storage areas for food, drink, rebreathing masks, etc  
 grey water recycler system  
 usually fed by external rain water tank  
 (or mains supply if available)  
 cold water storage/header tank  
 hot water storage/header tank  
 generator  
 water pump with connection  
 for external sprinkler system
- 3 Kitchenette**  
 sink - supplied from header tank,  
 waste to greywater treatment unit  
 wood burning stove with back boiler to heat water  
 small fridge (gas/electric)  
 acts as safety awning to ensure escape  
 access is possible from refuge

## pod plan

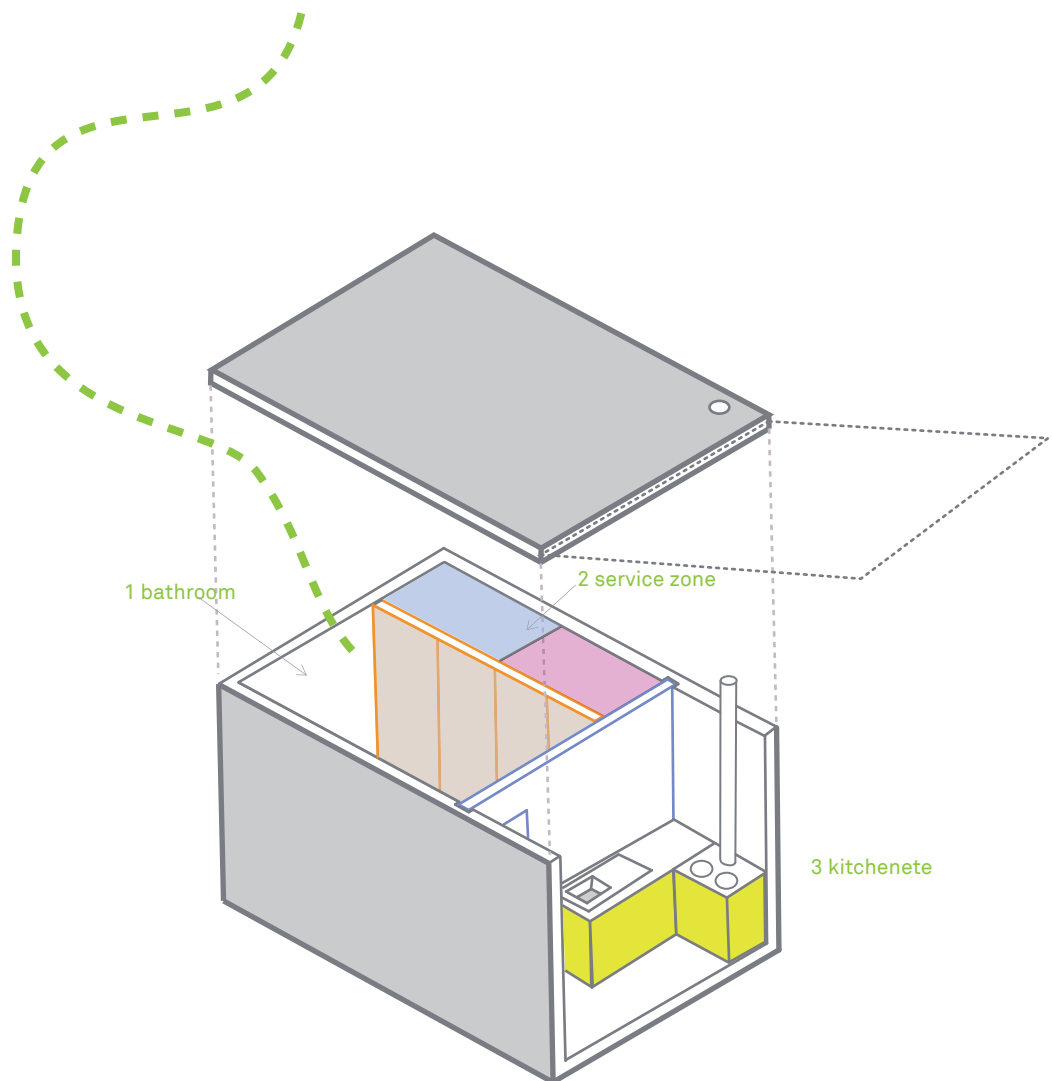
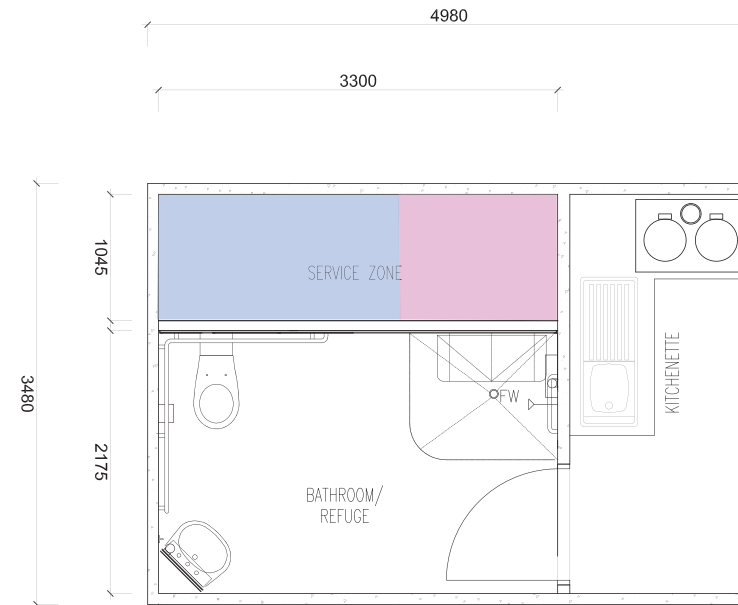

just like the bushland the houses will re-grow.

**proven technology**  
 Recently we have used the same pod module to provide student bedrooms to projects across NSW.  
 Further info [www.one2one.net.au](http://www.one2one.net.au)

